

# Interactive Flat Panel

## User Manual

## Product Installation

### Step1: Punching holes in the wall

Mark 8 holes location on the wall according to wall mounting bracket A and use the drill bit drilling the 8 holes. Depth of holes not less than 90mm (Ref. Picture 1)

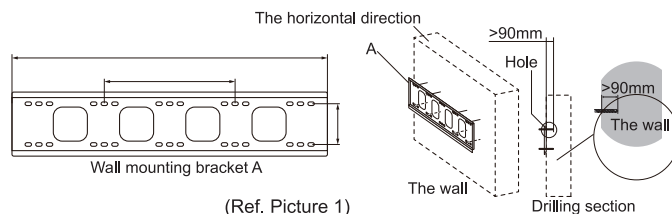

In order to ventilate and dissipate heat to ensure the normal operation of the device, please keep enough distance between the device and other objects. It is recommended that the top and bottom are more than 20cm away from the mounting surface, and the left and right sides, the rear are more than 10cm away from the mounting surface.

### Step2: Expansion bolt installation

Press the expansion bolt into 8 holes. (Ref. Picture 2)

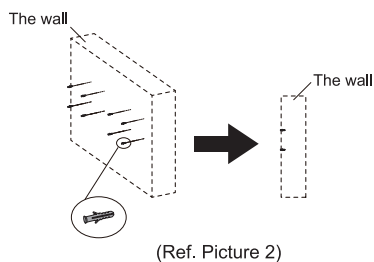

### Step3: Wall mounting bracket A installation

Install the wall mounting bracket A with 8pcs screws and gaskets. Please ensure that the wall mounting bracket A is installed horizontally. (Ref. Picture3)

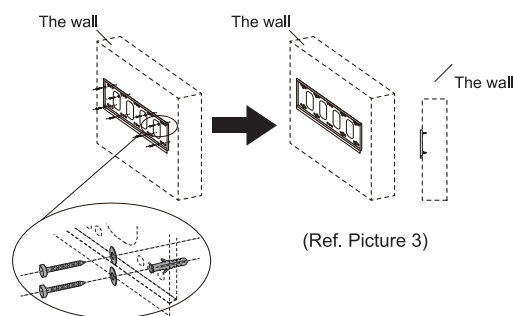

### Step4: Install the left& right hang bracket B to Interactive Flat Panel

Use screws fix the hang bracket B at the back of Interactive Flat Panel. Please check the direction of hang bracket B before installation. (Ref. Picture 4)

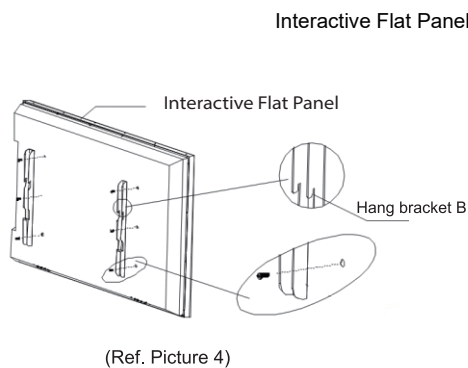

### Step5: Hang Interactive Flat Panel on the wall mounting bracket A

Hanging the left &right hang bracket B to the wall mounting bracket A, please ensure two hang brackets B total hang on wall mounting bracket A, then tighten the screws of hang bracket B to prevent it slide. (Ref. Picture5)

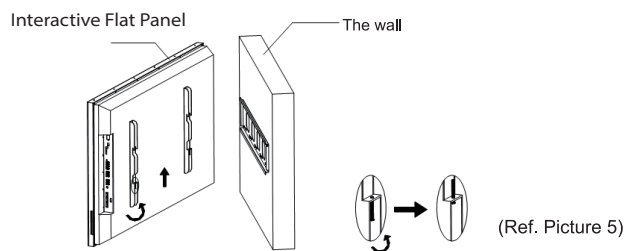

\*Note: The instruction just for installation diagram, it didn't appeared according to the actual size and ratio.

## Attentions

### Before use:

- It is advised to use the provided power cord in the package with this product.
- Do not leave it under direct sunlight or heaters.
- Do not place this product in any humid, dusty or vibrating locations.
- Use a soft, dry cloth for cleaning instead of any volatile solvent.
- When the device is not in use for a while, please turn off the power.

### During use:

- Use AC 100~240 V, 50/60 Hz only.
- Recommended environmental conditions: Temperature: 0°C~40°C; Humidity: 10%~90% (Non-Condensing).
- Do not touch the power cord with wet hands.
- The product should be set up before boot, should not lying horizontally.
- Do not disassemble the product in any way.
- All repairs should be referred to professional technicians.

\*Note: Please read this user manual carefully before using the product!

## OPS Installation



The built-in computer does not support hot plugging. Therefore, you must insert or remove the built-in computer when the display is powered off. Otherwise, the display or built-in computer may be damaged.

Perform the following steps to install the built-in computer:

Step1

Unscrew the screws by hand to remove OPS shielding cover.

Note: This step is optional and applies to models with shielding cover.

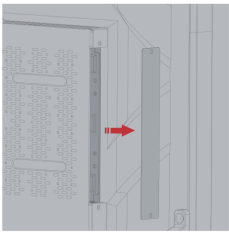

Step2

Push OPS into the port at the rear of the machine from right to left.

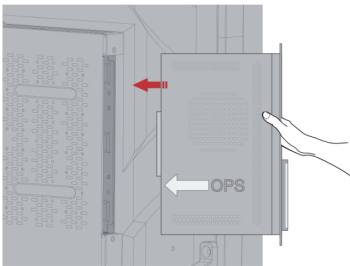

Step3

Secure OPS to the machine by using the screws.

Note: If the screen fuzzes, flashes or no signal is received from OPS channel after turning on the power, it means that OPS has not been properly installed. Please check it and re-install.

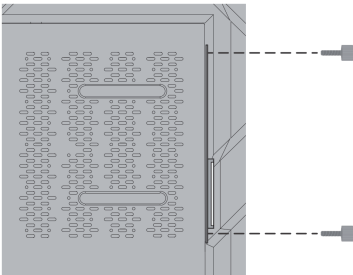

Ports Illustration

Name	Ports	Function
HDMI		Connect with external PC or device by HDMI cable
DP		Connect with external laptop or device by DP cable
VGA		Connect with external laptop or device by VGA cable
USB3.0/USB2.0		Connect with USB keyboard / U disk / Mobile HD
Touch-USB	or	Connect with touch USB cable to realize the touch function of external device
LAN		Connect with network cable
RS232		Connect with RS232 cable to realize serial communication transmission of data
Type C		Connect with Type C cable for power supply and data transmission
SPDIF	or	Connect with SPDIF cable for high-fidelity audio transmission
Earphone		Connect with Earphone cable to get sound

\*Note: The design and quantity of ports & buttons are different by model.

Enable the Device

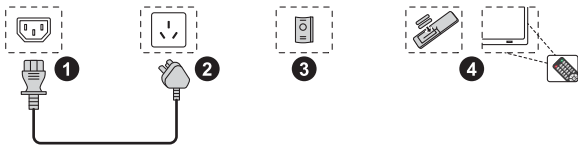

1. Connect the power cord to the port at the back of the device.
2. Plug the power cord to the electrical socket.
3. If the power LED light is not turn red please turn on the rocker switch at the back of the device.
4. Press power button or put the battery in to remote control and use remote control to power on the device.

External Computer Connection

1. Plug the HDMI cable or VGA cable to the external computer.
2. Plug the touch USB cable to the external computer.
3. Press the SOURCE (INPUT) button to change different channels.

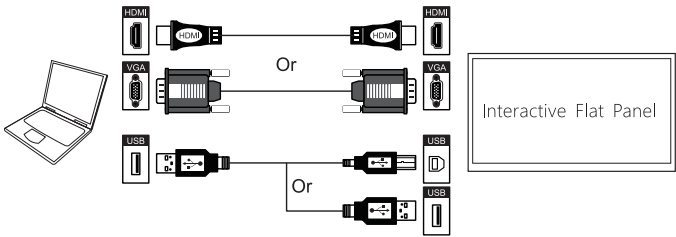

\*Note: The external computer connect to front HDMI, the touch port should be front Touch USB, if the HDMI change to HDMI of the back, the touch port should be touch USB of the back.