

Handheld Label Printer E1000PRO User Manual

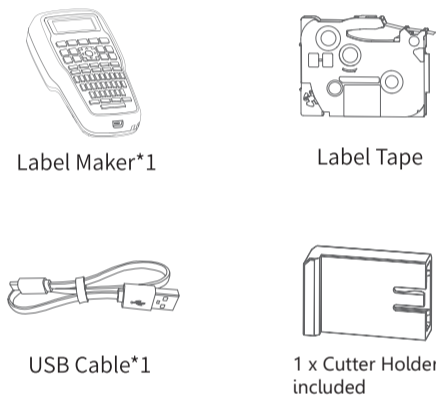

Tel: (RSA) 010 140 4900 / Email: sales@parrot.co.za
www.parrot.co.za

01. Contents Checklist



Note The quantity of included label tape is subject to the actual delivery

02. Specification

E1000 Pro	
Max label height	12mm
Max print height	9mm
Print Technology	Thermal Transfer
Print Resolution	180DPI
Print Speed	10mm/s
Cutting Method	Manual cutting
Automatically turns off after	5 minutes
Automatic memory function	Support
Ribbon tightening function	Support
Consumables identification function	Manual selection
Power supply	Type-C port or 6 AAA alkaline batteries (Batteries not included)
Item Size	213*116.5*61.5mm
Font Style	Normal, Bold, Italic
Width	Normal, x2, x1/2
Frame	Support
Label Length	The label length for each label depends on the label content, which is up to 800mm
Margin	Full: Equal margins on both sides are 25mm Half: Equal margins on both sides are 12mm Narrow: Equal margins on both sides are 4mm
Mirror Mode	Support

E1000 Pro	
Available Memory	9 labels. Up to 80 characters per label
Switching upper case/Lower case	Press Caps button to switch to upper case or lower case
Shortcut Keys	① Shift+Print key=Multiple Copies[1-9] ② Shift+Number (0-9)=Access to special characters

03. Parts Description

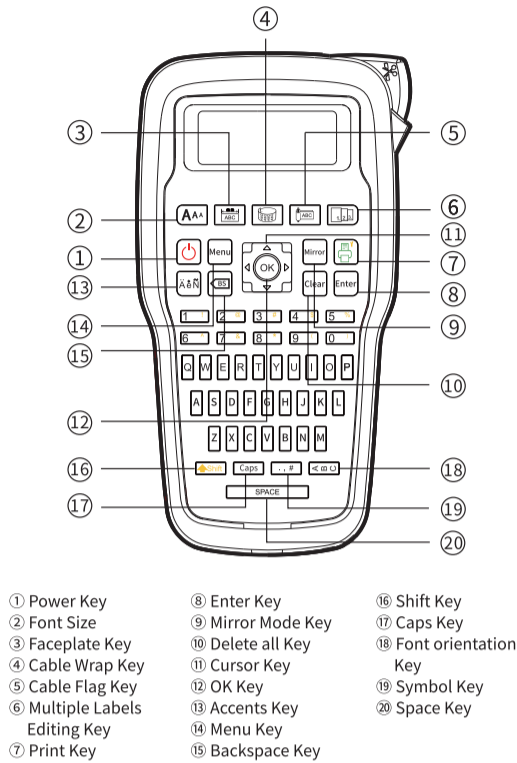

- ① Power Key
- ② Font Size
- ③ Faceplate Key
- ④ Cable Wrap Key
- ⑤ Cable Flag Key
- ⑥ Multiple Labels Editing Key
- ⑦ Print Key
- ⑧ Enter Key
- ⑨ Mirror Mode Key
- ⑩ Delete all Key
- ⑪ Cursor Key
- ⑫ OK Key
- ⑬ Accents Key
- ⑭ Menu Key
- ⑮ Backspace Key
- ⑯ Shift Key
- ⑰ Caps Key
- ⑱ Font orientation Key
- ⑳ Space Key

04. Turning on the Power

Method I: Power via the Type-C port (5V=2A) Method II: Power on with AAA alkaline battery

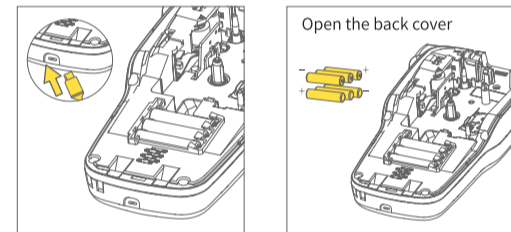

05. Installation for Label Tape

- Take out the label tape & remove the blue card
- Make sure the end of tape passes through both tape guide ① & ②, then extend the end of the tape by about 1.18 inch (3cm) from tape guide ②.

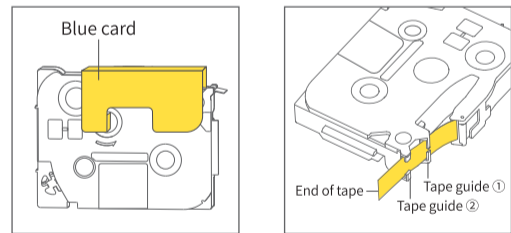

- Turn the toothed wheel in the direction of the arrow on the label tape until tight to avoid damage.

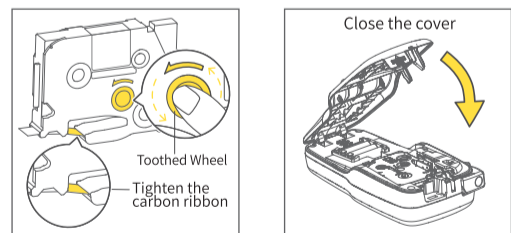

- Install the label tape correctly as indicated, & make sure that the extended tape comes out through the tape exit slot of label maker.

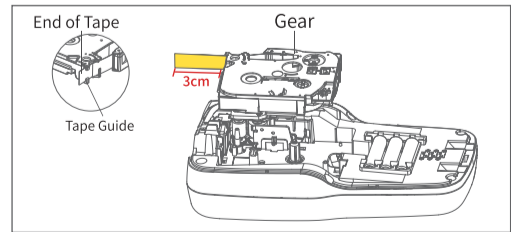

Note We recommend installing label tape after the label maker power on.

06. Common Functions

6.1 Language

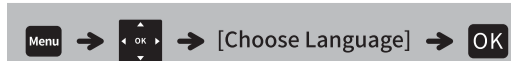

6.2 Select label width

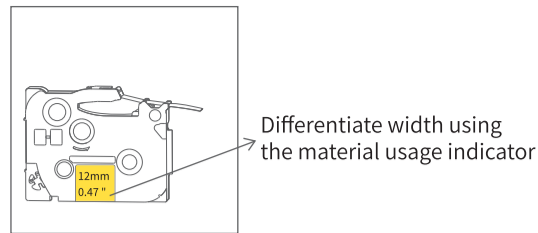

- When using the label maker for the first time, install the label tape & select the label width. Use the navigation keys to select the label width

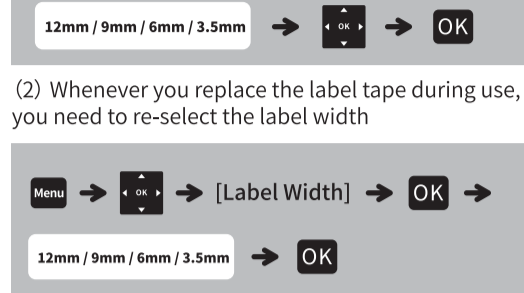

6.3 Text format

(1) Font Size

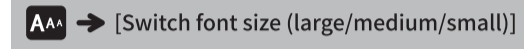

(2) Font Style



(3) Width

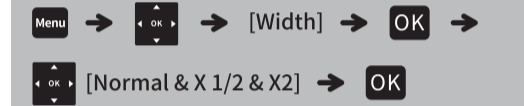

(4) Symbol

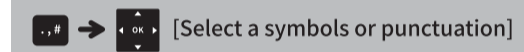

(5) Frame



(6) Switching Upper Case/Lower Case

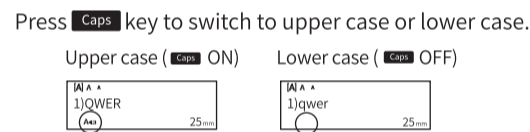

(7) Setting Margins

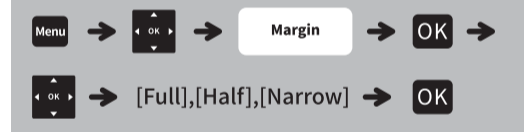

Margin function sets equal margins on both sides of the text

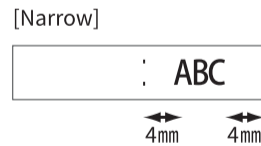
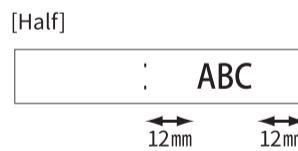
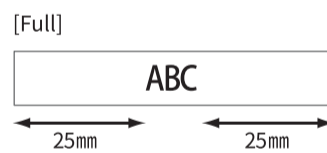

Note ① After setting [Half] & [Narrow], the display shows the label length from the printed dots (:) to the end of the label
② In order to save label tape, set the margin to [Narrow]

(8) Entering multiple lines of text

a. 12mm wide label tape: Support print 4 lines of text, After entering the 4th line of text, do not press the [Enter] key, otherwise the error message "Please reduce the number of lines!" will be displayed.

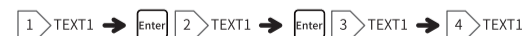

b. 9mm wide label tape: 3 lines of text can be printed. After entering the 3rd line of text, do not press the [Enter] key, otherwise the error message "Please reduce the number of lines!" will be displayed.
c. 3.5mm, 6mm wide label tape: 1 line of text can be printed, after entering the first line of text, do not press the [Enter] key, otherwise the error message "Please reduce the number of lines!" will be displayed.

6.4 Clearing

- Press [BS] [BS (backspace) key] to delete the letters one by one
- To delete all text and format:



To delete all text only:



6.5 Label printing function

- Printing single copies
 - If you need only 1 copy of the label, press [print key]
 - To prevent damage to the tape, do not touch the cutter lever while the screen displays "Printing...." or "Feeding...."
 - To cut off the label, push the tape cutter lever on the upper-right corner of the printer
 - Peel the printed label from the backing & apply the label

- Printing multiple copies
Use the navigation keys to select the number of copies



The number of copies can also be specified by pressing a number key



Note Up to 9 copies of each label can be printed at a time

6.6 Multi-copy editing function

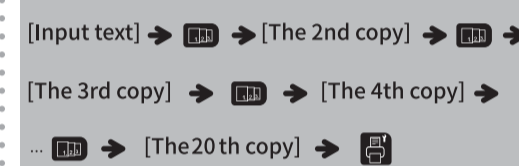

Note Multi-copy editing: Use this function to continuously edit up to 20 different labels

Review/Modify the Text

① Browse up & modify

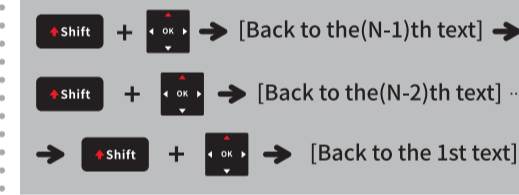

② Browse down & modify

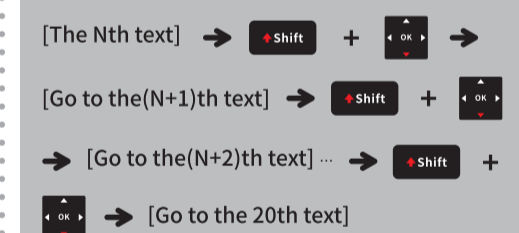

6.7 Selection of Cutting Method

Turn on Cutting (If print the label with "narrow margin" or "half margin", or print several labels, it is recommended to turn on "Cutting" to manually cut the label one by one, & no need to cut by scissor.)

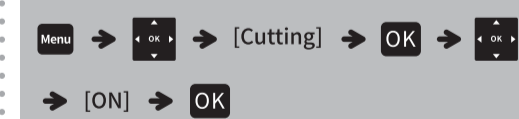

Turn off Cutting (Manually cut the whole label after printing, then cut the label by scissor when needed)



Note Please do not press the cutter button before a reminder to cut, otherwise it will prompt "Cutter Error!" & the printing work will be terminated.

6.8 Set mirror mode

- Mirror mode must be turned off when using laminated label tapes
- Mirror mode must be turned on when using cloth label tapes & non-laminated label tapes



6.9 Saving label Files

Save up to 9 label files & recall them later for printing, allowing editing & overwriting of stored label files.

a. Save

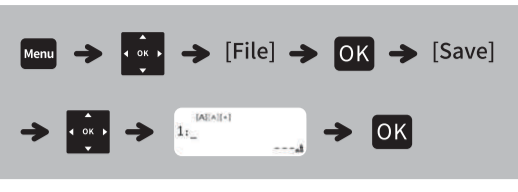

b. Open

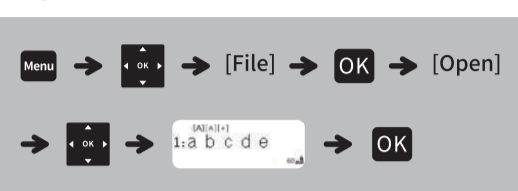

Note If you try to store a label file when there is already a label file stored to that number, a message "Cover?" will appear. Press [OK key] to replace the previous label file with the new one. Press [Backspace key] to cancel.

6.10 Other printing types

(1) Cable Wrap

You can create a label that can be wrapped around a cable or wire. The input text line is rotated 90° counter clockwise & printed on a label whose length is automatically determined by setting the cable diameter

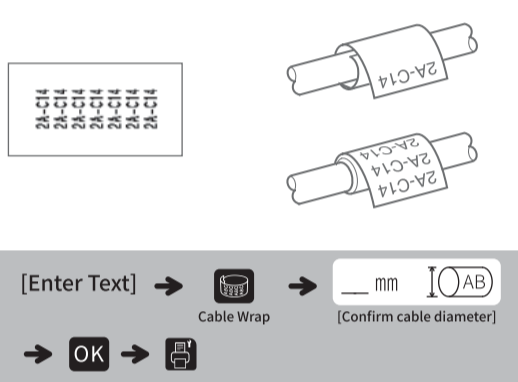

Note Only Flexible ID label tape can be used to print cable wrap labels

(2) Cable Flag

With this function, a label can be wrapped around a cable or wire with its ends stuck together to form a flag. The input text lines are printed at the both ends of a label. You can select the cable diameter. The label length is automatically adjusted according to the text length.

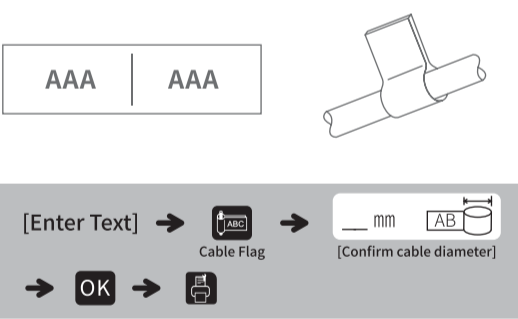

Note Only Flexible ID label tape can be used to print flag labels to label cable & wires. Use the cable flag function when the diameter of the object is less than 3mm

(3) Faceplate

Labels printed with this function can be used to identify various components or panels.

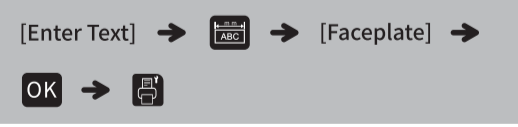

6.11 Barcode

You can print barcodes on labels with this function

Item	Description
Protocol	CODABAR, CODE39, ITF25, CODE128, EAN-13, EAN-8, UPC-A, UPC-E
Width	Small Large
Bottom Text	OFF ON
Check Code	OFF ON(only applied to CODE39,ITF25 & CODABAR)

(1) Barcode Set

When you need to print a barcode on a label for the first time, you can choose a barcode set to do it.

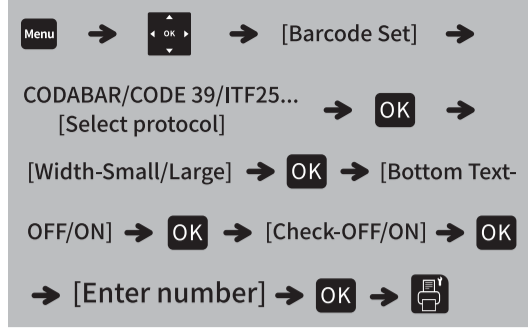

Note Check only appears on the LCD after selecting CODE39,ITF25 or CODABAR.

(2) Barcode Input

When you need to reprint another label with the last barcode you can enter text directly by barcode input

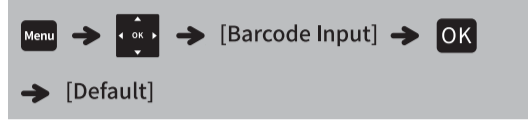

6.12 Entering accented characters

Press an alphabetic character, then press [accented character key], the accent options of that alphabetic character are displayed

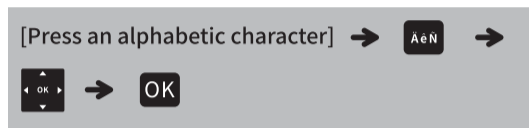

Note To cancel the current operation, press [BS (Backspace)key]

6.13 Reset the E1000 Pro

You can reset your E1000 pro labeling system when you need to initialize the settings, or if the E1000 pro is not working properly.

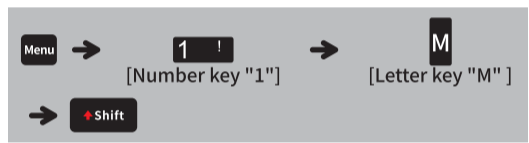

Note All text, settings & stored files are cleared.

7. Cleaning Guide for Label Maker

Use a cotton swab dipped in a small amount of alcohol, & wipe the print head gently

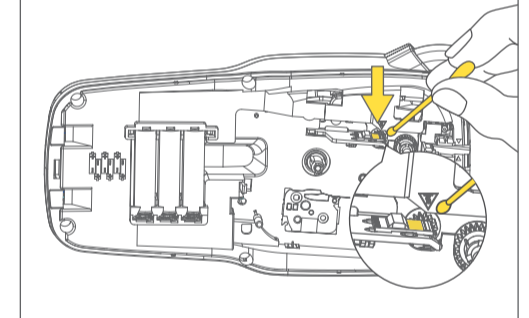

- The print head needs to be cleaned when printing is not clear.
- Make sure the power is turned off & the power cord is unplugged before cleaning the print head
- Wait until the alcohol evaporates & the print head is dry, then turn on the label maker to print & check the resulting print
- Do not scratch the print head with a hard object, otherwise the print head will be damaged & the printing effect may be compromised.

8. Replacing the Cutter Holder

If the label tape cannot be cut neatly after continuous use, please replace the cutter holder as shown in the following diagram.

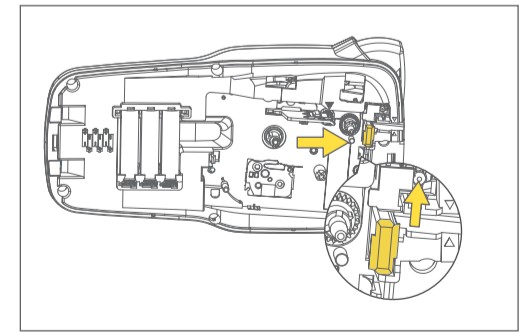

09. Troubleshooting

Message	Cause	Solution
Low Battery!	The batteries are weak	If using AAA alkaline batteries: replace them with new ones
Invalid!	An invalid number was entered as the label length, cable diameter or faceplate length	Correct entry
Text Limit!	The number of entered characters exceeds the label length	Reduce the text or select [Auto] as the label length
No Data!	① An attempt was made to print a label file when no data was stored in the memory. ② [Print key],[Enter key],[OK key],[Preview]was pressed when no text was entered.	Press [BS(Backspace)Key] to return to the edit page & enter text
Line Limit!	① 12mm :An attempt was made to enter a 4th line by pressing [Enter key] ; ② 9mm :An attempt was made to enter a 3rd line by pressing [Enter key] ; ③ 6mm :An attempt was made to enter a 1st line by pressing [Enter key] ;	Reduce lines
Text Full!	The maximum number of characters (80 characters for regular text) was already entered. Reduce numbers of characters to a maximum of 80	Reduce entry (reduce bytes please!)
Cutter Error!	The cutter lever was used during the printing process	Press [Print Key] and DO NOT TOUCH the cutter lever while printing
No Cassette!	There is no cassette in the label maker	① Input a cassette ② Cover the back of the device.

10. Additional Troubleshooting

Problems	Solutions
The display stays blank after turning on the device	① Check that the batteries are correctly inserted. ② If the batteries are weak, replace them. ③ If using the power adapter, make sure the cord is connected correctly & power is turned on
When the label is printed out, the margin (space) is too large on both sides of the text	See "Setting Margin" in this user manual & select [Half] or [Narrow] to have smaller margins for labels.
The printer does not print, or the printed characters are not formed correctly	① Check that the tape cassette has been inserted correctly ② If the tape cassette is empty, replace it. ③ Check that the cassette cover is fully closed.
A blank horizontal line appears through the printed label	There may be some dust on the printer head. Remove the tape cassette & use a dry cotton swab to gently wipe the printer head with an up- &-down motion. Or insert a print head cleaning cassette to clean the printer head more easily
The printer has "frozen up" (i.e. nothing happens when a key is pressed, even though the printer is on)	① Replace batteries in case the batteries are weak ② Restart the printer by pressing the Power key ③ If the two solutions above do not work, return to your seller
The power turns off when trying to print	① The batteries may be weak. Replace them. ② Check that the batteries are correctly inserted.
The tape does not feed correctly or the tape gets stuck inside the machine	① Check that the end of the tape feeds under the tape guides ② The cutter lever has been used while printing. DO NOT TOUCH the cutter lever during printing

11. Parrot Products Warranty

This product is provided a period of two (2) years from the date of purchase for defects in materials & workmanship (subject to the terms set forth below). It shall be returned to the dealer in either its original packaging or packaging affording an equal degree of protection. The following information must be presented to obtain Warranty Service: (a) the product, (b) proof of purchase, which clearly indicates the date of purchase & the product type, & (c) reason for return. This Warranty does not cover defects or damages that result from: (a) improper storage, misuse or abuse, accident or neglect, such as physical damage (cracks, scratches, etc.) to the surface of the product resulting from misuse; (b) contact with liquid, extreme humidity, extreme heat, or food; (c) use of the product or accessories for commercial purposes or subjecting the product or accessories to abnormal usage or conditions; (d) other acts which are not the fault of Dealer. This warranty does not cover damage due to improper operation, maintenance or installation, or attempted repair by anyone other than the dealer or the dealer's authorized repair center. This warranty does not cover defects or damages that result from the use of Dealer's branded or uncertified products, accessories, or other peripheral equipment.